

The
Renaissance XXII
Sale

APRIL 12, 2014

Saturday - 1 P.M.

Chappell's Sales Arena
Strafford, Missouri

“Renaissance XXII” Sale

April 12, 2014

Saturday - 1 P.M.

Chappell's Sales Arena - Strafford, Missouri

Chappell Sales Arena is located 6 miles east of Springfield. Please refer to map below.

~ Schedule of Events ~

Friday, April 11, 2014

Sale Cattle Available for Viewing All Day

Saturday, April 12, 2014

Lunch Available

1:00 p.m. - “Renaissance XXII Sale”

~ Local Points of Interest ~

Bass Pro Shop - One of Missouri's #1 Attractions

PFI - Missouri's Largest Western Store

Wilson's Creek National Battlefield & Museum

Missouri Sports Hall of Fame

45 Miles from Branson, Missouri

Springfield Cardinals

~ General Information ~

SALE HEADQUARTERS

Hampton Inn

2750 N. Glenstone • Springfield, MO • 417-869-5548

Special Rate mention Charolais Sale.

Econo Lodge

2611 N. Glenstone • Springfield, MO • 417-864-3565

AIR SERVICE

Springfield is served by many major airlines.

LOADING INFORMATION

No cattle will be loaded until the conclusion of the sale.

HEALTH

All cattle will be accompanied with proper health certificates for immediate shipment.

TERMS AND CONDITIONS

A standard set of terms and conditions will be available sale day.

INSURANCE

Insurance will be handled at the settlement desk.

Buyers unable to attend the sale may send their bids with the sale management, the auctioneer, or the special representatives. These bids will be handled in a confidential manner.

Sale Managed by:



John S. Mitchell, Jr.

870-897-5037

E-mail: jsmj39@live.com

Clifford C. Mitchell

405-246-6324

E-mail: ccmosu@msm.com

SALE DAY PHONES:

(870) 897-5037

(405) 246-6324

(417) 865-2163

AUCTIONEER

Col. Rob Nord - (217) 935-2656

SPECIAL REPRESENTATIVES

Tim Lackey, Missouri Cattleman, 660-676-2193

David Hobbs, The Charolais Journal, 913-515-1215

Brian Johnston, 417-372-2720

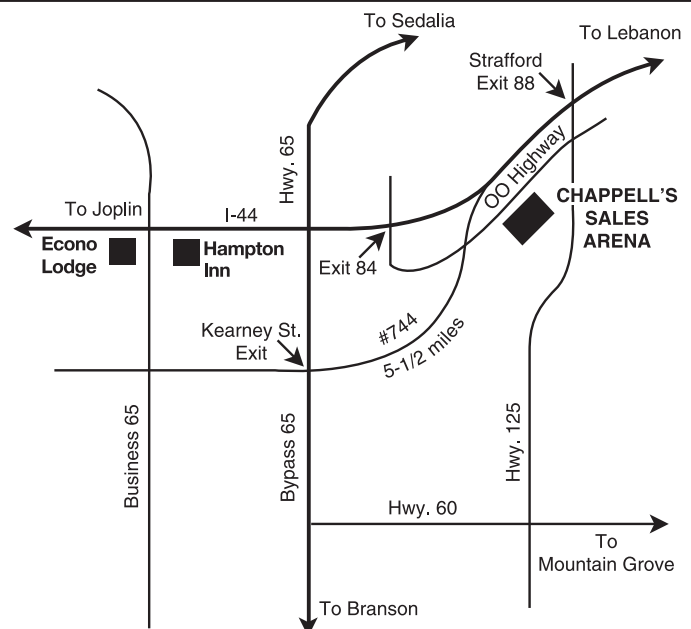



TR MR DIABLO 2742Z



TR MR Diablo 2742Z

Polled • EM830595

EPD - PE	
CE	-3.0
BW	1.8
WW	22.0
YW	43.0
MK	7.5
MCE	0.1
TM	21.0

Sparrows Sanchez 715T P	Sparrows Alcatraz 18N
CML Diablo 2X P	Sparrows Dana 321L P
CML Pld Wilma 3S P	Merit Vintage 4065 P
	Target Pld Ginny 40 P
TR Fire Water 5792 ET P	Thomas Oahe Wind 0772 ET P
HF Mustang Sally 904 Pld	Thomas Swisser Sweet 1764 ET
Wells JBJ Platinum Lady 336	GDSF JR Platinum 20K
	JBj Blizzette 724

- Offering a limited number of semen packages. \$1500 for 25 straws and 25 signings - Semen will be at the sale site. Bring your tank.
- What a unique opportunity. This is a futuristic genetic package that will be recruited by top breeders.
- The Canadian outcross DIABLO mated to MUSTANG SALLY, perhaps FIREWATER'S greatest daughter who commanded \$65,000 for half interest in the Embryos on the Snow Sale in Denver this year.
- Great bulls are produced by superior females. MUSTANG SALLY defines greatness. She generated over \$100,000 in sales at Denver, headed by \$20,000 for half interest in a son in the National Sale.
- The most versatile bull to come down the pipe in a long time, he will produce show cattle, club calves, and increase the value of your herd.
- Get on board now! No semen will be offered to the public until April 2015.
- Champion at the Black Hills Stock Show in 2014.

WILD INDIAN ACRES • THOMAS RANCH • MARK RICKABAUGH • FOGELSONG CHAROLAIS



Creek Cut Greta 576P ET



RF Greta 96Z



Creek Cut Greta 576P ET

9-2-06 • Polled • EF1059470

EPD - DIR	
CE	11.8
BW	-3.9
WW	20.0
YW	47.0
MK	12.0
MCE	7.5
TM	22.0

WCR Sir Tradition 066	WCR Sir Tradition 4402
M6 Grid Maker 104 PET	Ideal 809 45 OF 25
VCR Miss Mac IV 317	WCR Sir FA Mac 2244
	VCR Miss Duchess 113 Pld
WCR Sir FA Mac 2244	WCR Sir FAB Mac 809
RLL Goin' Places 1329PET	WCR Miss Century 920 TWN
VCR Miss Perfection 0119PD	WCR Sir Perfection 829
	73ACR MS Patsy W/152

Selling one successful FLUSH: 7 Frozen Embryos

- GRETA is one of the truly great GRID MAKER daughters and the most productive from GOIN' PLACES cow family.
- A daughter RF GRETA 96Z was champion at the ultra competitive Missouri State Fair, followed by division wins at the Junior National and Ft. Worth National.
- Sons by different sires have sold in three different states, daughters are easy fleshing and good milkers.
- GRETA is ready to be flushed and the work will be done by SEK in Kansas.

KINNEY CHAROLAIS

HERD BULLS



Lot 3 - Ace-Orr Efficient 972



Ace-Orr Efficient 972

10-17-09 • Polled • M793475

EPD - DIR	
CE	5.1
BW	1.5
WW	43.0
YW	91.0
MK	17.0
MCE	6.3
TM	39.0

WCR Sir Tradition 066
M6 Grid Maker 104 PET
VCR Miss Mac IV 317

WCR Sir Tradition 4402
Ideal 809 45 OF 25
WCR Sir FA Mac 2244
VCR Miss Duchess 113 Pld

LT Polled Value 9089
Orr's MS Mary 413P TW (*)
Orr's Lady Mary 105 Pld ET

WCR Prime Cut 764 Pld
LT Unlimited Maid 7184 P
WCR Prime Time 908 P
Orr's-JWK Lady Mary F041

- Selling one quarter and spring possession, April thru September, plus 100 units of semen, with the option to double the bid for an additional one half interest and full possession.
- How many times do you get the chance to purchase and walk a proven AI sire. It does not happen often and you could not ask for a better one.
- His EPD profile shows he is in the top 1% for YW, 2% for TM, 5% for WW and 9% REA and Milk. He could very well be the best son of the popular GRID MAKER. Progeny come easily, grow well, and are correctly structured.
- His dam is a standout in the Orr herd, continually producing top end sons and is a Dam of Distinction.

HALE FARMS & PETERSON FARMS CHAROLAIS



TB Adam 209 P

8-29-12 • Polled • M829688

EPD - BK	
CE	7.5
BW	1.3
WW	39.0
YW	71.0
MK	14.0
MCE	8.6
TM	33.0

VCR Sir Duke 914 Pld
M6 Full Throttle 2138 PET
M6 MS Mark 9485

WCR Sir Duke 761
WCR Miss Mac IV 534
LHD MR Silver Mark A35
Moores MS Elle 659 P

HEP King Grazer 25A
TB Grazer Plus 427 P
TB Miss Magic 210 P

BR Duke 261
HEP Miss Joan 10W
JWK Choice Plus E203 ET
TB Magic Wind 914 PET

BW 88 WW 585/97 YW 1036/101 ADG 2.82 SC

- A well muscled herd sire that combines structural correctness, muscling, pedigree and performance.
- His Weaning and Yearling EPDs in the top 5% of all non parents in the breed.
- He has the genetic ability to move your next calf crop a step ahead.

BEBOUT CHAROLAIS



Lot 6 - CR/RCR Lunch Time 2979



WH Pilot 232 LPD

11-7-12 • Polled • M834525

EPD - BK	
CE	-1.0
BW	2.8
WW	28.0
YW	50.0
MK	1.0
MCE	3.1
TM	15.0

PF Paratrooper 8235 P
JASR Wing Man 46X
JASR Fergie 47 T Pld

Bar5 MR Smokester 3126 P
Bar5 MS Smokester 3145 P
Bar5 Miss Cigar 3070P

Three Trees Wind 3001 ET
PF Miss Paradise 2155 P
TLC Integrity 5087P ET
Ace MS Megan Elk 09910-70R

JDJ Smokester J1377 P ET
Bar5 MS Mac 2026 Pld ET
LHD Cigar E46
RC MS Bud 418 Polled

BW 86 WW 648/94 YW 1136/99 ADG 4.30 SC

- He is the first WING MAN son to sell at public auction.
- Look at his Yearling Weight and ADG, he will add growth to his calves.
- Put these superior genetics to work in your herd.

WINDY HILL CHAROLAIS



CR/RCR Lunch Time 2979

11-8-12 • Polled • M829909

EPD - PE	
CE	7.0
BW	0.2
WW	34.0
YW	63.0
MK	7.0
MCE	4.8
TM	24.0

LT Rio Blanco 1234 P
VPI Free Lunch 708T
VPI Miss Duchess 404 P (*)

RCR Traditions Ned P0425
CR/RCR Renne 9830 P
RCR Miss Koko 4608

WCR Prime Cut 764 Pld
LT Prairie Maid 4054
WCR Prime Cut 764 Pld
VCR Miss Duchess 703 Pld

WCR Sir Tradition 066
RCR 8347 Polled
Baldrige Kojack 29K
RCR Gloria 2533 P

BW 87 WW 676/101 YW 1433/106 ADG 4.73 SC

- A total polled package here, he is thick made with an abundance of volume and correctly structured.
- His EPDs are in the top 20% for Calving Ease, 15% for Weaning, 9% for Yearling Weight, and 15% for Rib Eye area.
- This is a pedigree that is stacked from top to bottom with trait leaders.

RICKETTS CHAROLAIS RANCH



RCR Long Distance 3993

2-16-13 • Polled • M834994

EPD - PE	
CE	6.9
BW	-2.8
WW	23.0
YW	39.0
MK	13.0
MCE	2.0
TM	25.0

LT Silver Distance 5342P	LT Silver Yield 3196 P
LT Long Distance 9001 Pld	LT Mattie 9026 Polled
LT Belle 7026 P	LT Easy Pro 1158 Pld
	LT Belle 5110 Pld
M6 Gain & Grade 927 Pld	WCR Sir Duke 761
RCR Miss Katrina 7717 P	M6 Miss Mac 4140
RCR Francys Doll 1472 P	WCR Sir Tradition 066
	RCR Francys

BW 69 WW 604/100 YW 1260/100 ADG 4.10 SC

- Are you looking for Calving Ease! Stop here, a Birth Weight of 69. A Birth Weight EPD of -2.8 in the top 6% of the breed, plus a Calving Ease in the highest 20%.
- He also has a high Milk EPD, the ability to pass milking ability to his daughters.
- The genetic material from the third generation is awesome.

🌀 RICKETTS CHAROLAIS RANCH 🌀



Lot 7 - RCR Long Distance 3993



KC Oakdale Duke 302 P

4-1-13 • Polled

EPD - PE	
CE	1.6
BW	-0.5
WW	24.0
YW	49.0
MK	19.0
MCE	4.3
TM	31.0

VCR Sir Duke 135 Pld	VCR Sir Duke 914 Pld
Oakdale Duke 9003 P	VCR Miss Mac 902 Pld
Miss Velvetta Jane 630 P	JWK Striker D063 ET P
	WCR Miss Tradition 3478 P
LHD Cigar E46	LHD MR Perfect Y416 P
L+N Kindra 601 P ET	LHD MS Classic Bell X613
MS BBF Liberty Actor	CCC Knockouts Actor 3161
	Miss KC Liberty 314 P

BW 82 WW 610 YW 1165 ADG 3.47 SC

- This son of DUKE 9003 will add milk to his daughters, that will grow well.
- There is a demand nationwide for the quality females he will produce.
- His dam was a high seller in a past Renaissance sale.

🌀 KINNEY CHAROLAIS 🌀



BCR Larado 302 Pld

5-27-13 • Polled • M839491

EPD - PE	
CE	6.1
BW	0.7
WW	27.0
YW	53.0
MK	6.0
MCE	7.2
TM	20.0

LT Easy Blend 5125 Pld	LT Unlimited Ease 9108
LT Bridger 9191 Pld	LT Brenda 1014 Pld (*)
LT Carol 4105 Pld (*)	M6 Grid Maker 104 PET
	LT Carol 0271
LT Wyoming Wind 4020 Pld	Schurrtop 5627
BCR Laura 514 Pld	LT Chap's Lady 2170P
BCR Lorelei 326 Pld	RAC Goosecreek 3043 Pld
	DBL D Lacy Lila P9330

BW 78 WW 629/100

- A very well bred son of LT BRIDGER 9191 PLD.
- You must admire the influence of GRID MAKER, EASY BLEND and WYOMING WIND in his pedigree.
- He will sire calves with eye appeal and superior growth.

🌀 BEISWINGER CHAROLAIS 🌀



Big Creek Master Chief 334 Pld

3-21-13 • Polled • M840464

EPD - PE	
CE	4.3
BW	0.5
WW	22.0
YW	50.0
MK	14.0
MCE	2.9
TM	25.0

Schurrtop HCR Rancher	Schurrtop Ease 8953 Pld
Cooley Royce 1107T39	Schurrtop ML 6056 1184 P
MS Cooley S Duke 1107N60	WCR Sir Duke 17J ET P
	MS CCR Tradit 1107K7 PET
RC Budsmiyad 225 Polled	RC Bud 04 ET
Big Creek Sissy 843 P ET	Miss Showgun RC 416
Big Creek Angel P	ASC Eliminator 032
	Big CRK Babe Unlimited P

BW 85 WW 730

🌀 BIG CREEK CHAROLAIS 🌀



Big Creek Hustler 332 Pld

3-30-13 • Polled • M840463

EPD - PE	
CE	4.9
BW	0.2
WW	23.0
YW	54.0
MK	15.0
MCE	4.1
TM	26.0

Schurrtop HCR Rancher	Schurrtop Ease 8953 Pld
Cooley Royce 1107T39	Schurrtop ML 6056 1184 P
MS Cooley S Duke 1107N60	WCR Sir Duke 17J ET P
	MS CCR Tradit 1107K7 PET
LT Bluegrass 4017 P	LT Assertion 1277 P
Big Creek Belle 022 P	LT Pearl's Breeze 2236 P
Big Creek Sissy 843 P ET	RC Budsmiyad 225 Polled
	Big Creek Angel P

BW 82 WW 782

🌀 BIG CREEK CHAROLAIS 🌀



Lot 10 - Big Creek Master Chief 334 Pld

- These two closely related brothers are going to turn some heads sale day. Lots of eye appeal and muscle.
- The COOLEY ROYCE sons are getting plenty of attention for adding natural thickness in a moderate package, and out of one of the best producing cow families at Big Creek.
- These thick topped, free moving, clean fronted, smooth made bulls will make a positive contribution wherever they are used.
- Make your choice sale day, it may require a coin flip.



Lot 12 - DC Pomona Grid C305P



DC Pomona Grid C305P

3-7-13 • Polled

EPD - PE	
CE	3.0
BW	0.3
WW	35.0
YW	64.0
MK	14.0
MCE	0.0
TM	31.0

WCR Sir Tradition 066
M6 Grid Maker 104 PET
VCR Miss Mac IV 317

PLT Sir Dukes Flash 5527
DC MS Pomona Flash C808 P
DC MS Pomona Kojack C602 P

WCR Sir Tradition 4402
Ideal 809 45 OF 25
WCR Sir FA Mac 2244
VCR Miss Duchess 113 Pld
HCR Flash 5074 Polled
VCR Miss Duchess 552 Pld
Baldrige Kojack 29K
DC MS Pomona Mac C417 P

BW 99 WW 835/107

- A stout high volume son of GRID MAKER whose EPDs show the YW to be in the top 8%, WW and Milk 10%.
- Strong maternal traits from the years of breeding and selection in the Corman herd.
- A pedigree packed full of proven genetics.

🌀 CORMAN CHAROLAIS 🌀

SHOW HEIFER PROSPECTS



Lot 13 - G4 MS Kay



G4 MS Kay

10-1-13 • Polled • F1179131

EPD - PE	
CE	5.3
BW	0.8
WW	36.0
YW	73.0
MK	8.0
MCE	3.3
TM	25.0

LT Rio Bravo 3181 P
M6 New Standard 842 P ET
M6 MS Grid Maker 2175 ET

Ace MR Pro Cut 987
JASR Tanya 185Y Pld
SF Miss Tanya 0935 P

LT Rio Blanco 1234 P
LT 7N Of Duke 9083 Pld
M6 Grid Maker 104 PET
M6 MS E46's Duke 248 PET
LT Pro Assert 4211 P
Ace MS Nancy 9107 987 ET
LT Pro-Line 7039 P
SF Miss Wind 0513 P

- What a great inaugural consignment from the G4 program. A nice blend of performance and style.
- This little lady could bring home purple and retire as a front pasture donor.
- Her EPDs rank in the top 10% for WW and 3% for YW.

🌀 G4 RANCH 🌀



Big Creek HF Cassie 3112 P

11-6-13 • Polled • F1179401

EPD - PE	
CE	0.0
BW	0.7
WW	20.0
YW	36.0
MK	8.0
MCE	1.8
TM	18.0

Hoodoo Slasher 1144
JH Instant Classic 728
JH JO Dee 0418 Pld

Baldrige Kojack 29K
Big Creek Baby Chick P
Big Creek Dixie Chick P

Hoodoo Crook 7118
Miss Hoodoo Z6151
Mazeppa ED
JH Ally 8321 Pld

Baldrige Fastrack 82F
Baldrige Elvira 95H
WCR Prime Cut 764 Pld
Big Creek Dixie Bea P

- Look here! A maternal sister to one of the high selling heifers in last years sale.
- This girl is a show stopper. Sleek fronted, long bodied, and cool haired on a good set of feet and legs.
- She will make a front pasture cow once she is retired from the show ring.

🌀 BIG CREEK CHAROLAIS & HANKINS FARMS 🌀



WIA MS Sanchez Pld

9-21-13 • Polled • EF1179138



WIA MS Lady Sanchez Pld

9-19-13 • Polled • EF1179139

EPD - PE	
CE	-4.1
BW	2.3
WW	17.0
YW	32.0
MK	3.0
MCE	-2.7
TM	11.0

Sparrows Alcatraz 18N
Sparrows Sanchez 715T
Sparrows Dana 321 L

LHD Cigar E46
Bar5 Miss Cigar 3070P
RC MS Bud 418 Polled

Sparrows Matador 7K
Sparrows Barmaid 218H
ABC Hilton
ABC Dana H21 Poll

LHD MR Perfect Y416
LHD MS Classic Bell X613
RC Bud 04 ET
Miss Showgun RC 416



Lot 15 - WIA MS Sanchez Pld

- A pair of SANCHEZ daughters that are really fancy.
- The Canadian outcross bull is also the sire of DIABLO, ENCORE and RAZR, popular sires. ENCORE was the 2012 Reserve National Champion.
- These girls are out of an outstanding CIGAR daughter that traces to the only full sister to BUDSMYDAD and comes from a long line of revenue generators.
- Miss Cigar 3070 is a donor for Suttles.
- Help yourself with flush mate sisters, shortcut to quick progress in your breeding program.

🌀 WILD INDIAN ACRES 🌀



Baney MS Firewater 3004 Pld

8-2-13 • Polled • F1179393

EPD - PE	
CE	2.4
BW	1.7
WW	25.0
YW	48.0
MK	8.0
MCE	3.4
TM	20.0

Thomas Oahe Wind 0772ET P
 Baney Firewater 7048 P ET
 Thomas MS Cigar 4756 PET

LT Wyoming Wind 4020 Pld
 Thomas MS Camelot 5646
 LHD Cigar E46
 Thomas MS Bonanza 8698

M6 Grid Maker 104 PET
 Baney MS Grid Maker TW 8108 P
 Baney Primewind Beau 1B3

WCR Sir Tradition 066
 VCR Miss Mac IV 317
 WCR Prime Cut 764 Pld
 Baney Wind Beauty IB Pld

- This fancy show prospect is sired by a full brother in blood to FIREWATER 5792. She'll know her way around the tanbark.
- She should be very competitive in the summer division.
- It never hurts her maternal ability as a cow with GRID MAKER as the maternal grand sire.

🔗 BANEY CHAROLAIS 🔗



Lot 17 - Baney MS Firewater 3004 Pld



Lot 18 - SKS Lucy A93



SKS Lucy A93

9-15-13 • Polled • F1173992

EPD - PE	
CE	0.3
BW	0.4
WW	33.0
YW	52.0
MK	5.0
MCE	-1.9
TM	21.0

Hoodoo Slasher 1144
 D R Revelation 467
 DR WC Forever Lucy 372ET

Hoodoo Crook 7118
 Miss Hoodoo Z6151
 Baldrige Cadillac 74E
 JD MS Commander B309

Keys McHenry 24M
 DDC Trudy U15
 Bara MS Trademark 1P

Keys Handyman Pld 255H
 Miss Key Diana 102G PL
 CJC Trademark H45
 LHD MS Cigar J349

- A really good REVELATION daughter that will be competitive on the tanbark.
- She has a Weaning EPD in the top 20%, growth plus!
- This stylish heifer is really gentle and ready to go.

🔗 SKEANS CATTLE CO. 🔗

COWS & CALVES



DC MS Pomona Mac Duke C915C

4-9-09 • Polled • F1117286

EPD - DIR	
CE	11.6
BW	-4.5
WW	17.0
YW	31.0
MK	7.0
MCE	5.4
TM	15.0

VCR Sir Duke 914 Pld
 DC Pomona Duke C702P
 DC MS Pomona Track C503P

PF 809CR P ET
 DC MS Pomona Mac C521P
 DC MS Pomona Flash C201P

WCR Sir Duke 761
 WCR Miss Mac IV 534
 Baldrige Fasttrack 82F
 DC MS Pomona Flash C203P

WCR Sir FAB Mac 809
 JWK Caroline G003 ET
 PLT Sir Dukes Flash 5527
 DC MS Pomona Ease C011P

- 19A - Heifer calf #324, born 8-26-13, sired by M6 GRID MAKER 104 PET. Her EPDs will be +9.0; -2.0; +24.0; +48.0; +11.0; +4.3; +26.0. Above breed average for every trait.
- Put her Calving Ease and low Birth Weight EPDs to work in your herd to produce sons with easy calving ability. Safe in calf to COOLEY ROYCE 1107T 39, bred 11-14-13.

🔗 CORMAN CHAROLAIS 🔗



Lot 20 - Link MS L823 Sky 34R P



Link MS L823 Sky 34R P

9-27-08 • Polled • F1109635

EPD - DIR	
CE	2.1
BW	2.4
WW	33.0
YW	54.0
MK	13.0
MCE	5.4
TM	30.0

LHD MR Perfect Y416
 RCC-LT Big Sky A187 P ET
 Polled Miss Millie C323

M6 Grid Maker 104 PET
 BPC Agatha GM 34R P (*)
 WM MS AG Ali 262 PET

WCR Sir Perfection 734
 LHD MS Showme Off W159
 Shultz Tornado Poll 755
 Miss Millie 432

WCR Sir Tradition 066
 VCR Miss Mac IV 317
 LHD Ali Mark T214
 NF Agatha 9581 Polled

- 20A - Polled bull calf born 8-29-13, BW 83, sired by M6 SHOCK & AWE 9104 P who is a son of WIND 0383. His EPDs are +7.8; -0.2; +31.0; +55.0; +11.0; +6.7; +27.0.

- A powerful brood matron who is out of a Dam of Distinction, a cow that has a REA EPD in the top 1% and 15% for Weaning.
- Safe in calf. Bred 11-23-13 to LT REWARD, a LEDGER son, and exposed to 1A MR SANDMAN after 12-20-13.

🔗 LINK CHAROLAIS 🔗



TB Loving 801P

11-20-08 • Polled • F1099757

EPD - DIR	
CE	0.6
BW	1.1
WW	38.0
YW	61.0
MK	11.0
MCE	-3.3
TM	30.0

WCR Sir Impressive 8191P
 TB Boaz 613 P
 TB Dukes Sweetheart 415 PET

WCR Sir Impressive 8191P
 TB Rachael 606 P
 TB Sweet Choice 234 P

JWK Impressive D040 ET
 WCR Miss Paul 8041
 VCR Sir Duke 914 Pld
 Baldrige Sweetheart 53D

JWK Impressive D040 ET
 WCR Miss Paul 8041
 JWK Choice Plus E203 ET
 Caney Fork Venus 46 P

- 21A - Polled bull calf born 8-30-13, BW 92, sired by M6 NEW STANDARD 842 P ET, he is a good one. His EPDs are excellent +5.3; -0.1; +43.0; +82.0; +9.0; +0.4; +31.0.

- A good milking cow that has been a consistent producer in the Bebout herd.
- Safe in calf. Bred 11-30-13 to M6 NEW STANDARD 842 P ET, and then exposed to TB ABRAHAM 212P, a son of HBR CANNON 2250.

🔗 BEBOUT CHAROLAIS 🔗



TB Anna 744

10-11-07 • Polled • F1082239

EPD - DIR	
CE	4.3
BW	0.7
WW	23.0
YW	51.0
MK	18.0
MCE	2.5
TM	30.0

TB Plus 206 P ET	JWK Choice Plus E203 ET
TB Plus 426 P	JWK Verna G275 ET
JWK Imogene J124 ET	VCR Sir Duke 914 Pld
	Raasch MS Fabmac 73E ET
TLC Direction 8032P ET	ASC Eliminator 032
TLC Miss Stormy 2220P	Miss MT 810
LC Germaine	WW Sir Cardinal 2090
	ABC Germaine 834 Polled

- 22A** - Polled heifer calf born 9-21-13, sired by TB JAMES 104P TW, a son of HBR CANNON 2250. Her EPDs are +1.7; 1.1; +34.0; +64.0; +18.0; +0.7; +36.0, replacement quality.
- A large framed, long sided cow with a Total Maternal EPD in the highest 9% of all Charolais cows.
 - Safe in calf. Bred 11-30-13 to M6 NEW STANDARD 842 P ET, and then exposed to TB ABRAHAM 212P.

🌀 BEBOUT CHAROLAIS 🌀



Lot 23 - Link MS 847 Sky 536 P



WH Toni 813 P

8-19-08 • Polled • F1099494

EPD - DIR	
CE	1.1
BW	2.2
WW	30.0
YW	46.0
MK	6.0
MCE	5.0
TM	20.0

LT Wyoming Wind 4020 Pld	Schurrtop 5627
LV Guardian Angel R34 Pld ET	LT Chap's Lady 2170P
Big Creek Angel P	ASC Eliminator 032
	Big CRK Babe Unlimited P
GS Performac 7090 P	Morrison's Hillcrest Mac
WH Harriett 2113 Pld (*)	Pomona Duch
WH Tiffany 9117 Pld	TWJ Advantage Point 554P
	WH Harriett 6102 Pld

- 25A** - Polled heifer calf born 1-12-14, and sired by TLC INTEGRITY 5087 P ET. Her EPDs are +0.2; +2.3; +30.0; +53.0; +6.0; +4.2; +21.0, well above the breed average for growth.
- An outstanding young cow in her prime producing years.
 - Her REA EPD is in the top 4% of all producing cows in the breed.

🌀 WINDY HILL CHAROLAIS 🌀



Lot 27 - DC MS Pomona Flash C002P



Link MS 847 Sky 536 P

9-24-08 • Polled • F1109637

EPD - DIR	
CE	3.0
BW	1.9
WW	29.0
YW	50.0
MK	14.0
MCE	5.6
TM	28.0

LHD MR Perfect Y416	WCR Sir Perfection 734
RCC-LT Big Sky A187 P ET	LHD MS Showme Off W159
Polled Miss Millie C323	Schultz Tornado Poll 755
	Miss Millie 432
LC-Ace Prime Up 9119PET	WCR Prime Cut 764 Pld
Link 536 MS Kenco Up 3478 P	WCR Miss L06 9407 ET
WCR Miss Tradition 3478	WCR Sir Tradition 066
	WCR Miss Duke 914

- 23A** - Polled bull calf born 11-26-13, BW 90, sired by M6 SHOCK & AWE 9104 P. His EPDs are +8.2; -0.5; +29.0; +53.0; +11.5; +6.8; +26.0. All traits exceed the breed average.
- Her EPDs for REA in the breeds top 6%, had a Yearling ratio of 107. A pedigree featuring PRIME CUT, 066, 914, and MR PERFECT.
 - Safe in calf. Exposed to 1A MR SANDMAN by ACE, 12-1-13 to 3-1-14.

🌀 LINK CHAROLAIS 🌀



RCR Miss Freedom 0861

2-21-10 • Polled • F1125084

EPD - DIR	
CE	1.3
BW	0.9
WW	28.0
YW	48.0
MK	7.0
MCE	2.4
TM	21.0

LT Rio Blanco 1234 P	WCR Prime Cut 764 Pld
VPI Free Lunch 708T	LT Prairie Maid 4054
VPI Miss Duchess 404 P (*)	WCR Prime Cut 764 Pld
	VCR Miss Duchess 703 Pld
RCR Traditions Ned P0425	WCR Sir Tradition 066
RCR 5642 P	RCR 8347 Polled
RH Clara's Jewel	Double D Polled 773
	Rola's Lady Clara Pld

- 24A** - Polled herd sire prospect, #049 born 10-1-13, sired by LT LONG DISTANCE 9001. His EPDs are +4.7; -1.4; +24.0; +39.0; +14.0; -0.2; +26.0.
- This good young cow has a beautiful udder and milks well.
 - Rebred 1-4-14 to LT LEDGER 0332 P and safe in calf.

🌀 RICKETTS CHAROLAIS RANCH 🌀



DC MS Pomona Duke C010P

3-23-10 • Polled • F1133633

EPD - DIR	
CE	12.8
BW	-5.7
WW	21.0
YW	35.0
MK	11.0
MCE	4.7
TM	21.0

VCR Sir Duke 914 Pld	WCR Sir Duke 761
DC Pomona Duke C702P	WCR Miss Mac IV 534
DC MS Pomona Track C503P	Baldrige Fasttrack 82F
	DC MS Pomona Flash C203P
PLT Sir Dukes Flash 5527	HCR Flash 5074 Polled
DC MS Pomona Flash C808 P	VCR Miss Duchess 552 Pld
DC MS Pomona Kojack C602 P	Baldrige Kojack 29K
	DC MS Pomona Mac C417 P

- 26A** - Polled heifer calf born 2-20-14, sired by LT LEDGER 0332, who has taken the breed by storm. Her EPDs are +10.0; -3.5; +28.0; +56.0; +11.5; +5.2; +26.0.
- A good Corman bred cow here, she has a beautiful udder and is entering her prime.
 - Study your lesson. The LEDGER calf could pay the whole ticket. It was hard for Butch to sell this one. Check the Calving Ease EPD.

🌀 ROCKING S RANCH 🌀



DC MS Pomona Flash C002P

2-26-10 • Polled • F1133628

EPD - DIR	
CE	-2.9
BW	-0.5
WW	23.0
YW	40.0
MK	7.0
MCE	-8.5
TM	18.0

HCR Flash 5074 Polled	HCR Exodus 9033 Polled
PLT Sir Dukes Flash 5527	Miss HCR Mac 2015 Polled
VCR Miss Duchess 552 Pld	VCR Sir Duke 914 Pld
	VCR Miss Mac IV 8803 Poll
Pomona Paul 109/9 ET	Paul 109/9
DC MS Pomona Paul C209 P	WCR Miss Mac 9516 ET P
DC MS UNLTD Pomona C214P	BCR Polled Unlimited 003
	DC Miss Pomona Roxy 837P

- Due prior to the sale to DC POMONA LONG PROGRAM C931P. The EPDs will be +1.7; +0.3; +23.0; +37.0; +13.0; +2.3; +24.0.
- Here is a young cow just entering her prime producing years.
- The cows from the Corman herd have an excellent history of productivity.

🌀 CORMAN CHAROLAIS 🌀



NF Audrey 630 Polled

3-27-06 • Polled • F1049353

EPD - DIR	
CE	3.1
BW	-0.7
WW	24.0
YW	48.0
MK	14.0
MCE	2.5
TM	26.0

VCR Sir Duke 135 Pld	VCR Sir Duke 914 Pld
Oakdale Duke 9003P	VCR Miss Mac IV 902 Pld
Miss Velveeta Jane 630	JWK Striker D063 ET
	WCR Miss Tradition 3478
NF Bud-Bond 9924 Polled	RC Budsmiyad 225 Polled
NF Audrey 4007 Polled	NF Exposure 9611 Polled
NF Audrey 9609 Polled	Serendipity-Bond-007
	NF Audrey 8868 Polled

- A maternal powerhouse with a 14 Milk EPD. Due before the sale to TCC JUNGLE CAT, he is from National Champion parents. The EPDs for this calf are +2.5; +0.5; +24.0; +48.0; +10.0; +5.7; +22.0.
- The daughters of DUKE 9003 have made a positive impact in the herds they are in.

WILD INDIAN ACRES



NF Misty 680 Polled

6-6-06 • Polled • F1049432

EPD - DIR	
CE	4.5
BW	-2.2
WW	18.0
YW	42.0
MK	11.0
MCE	4.1
TM	20.0

VCR Sir Duke 135 Pld	VCR Sir Duke 914 Pld
Oakdale Duke 9003P	VCR Miss Mac IV 902 Pld
Miss Velveeta Jane 630	JWK Striker D063 ET
	WCR Miss Tradition 3478
NF Perfect Solution Pld	NF Dynamite 9731 Polled
NF Misty 325 Polled	NF Exposure 9668 Polled
NF Misty 9836 Polled	NF Improver 9623 Polled
	NF Misty 9605 Polled

- Due before the sale to TCC JUNGLE CAT, the high selling bull at the Iowa Beef Expo. The projected EPDs for this calf are -0.3; +0.5; +24.0; +48.0; +10.0; +5.7; +22.0.
- This OAKDALE DUKE 9003 daughter combines Calving Ease and Milk.
- Bred in the Nord herd long known for superior performance.

WILD INDIAN ACRES

FIRST CALF HEIFERS



BCR Katie 112 Pld

12-20-11 • Polled • F1153534

EPD - BK	
CE	6.7
BW	0.3
WW	24.0
YW	46.0
MK	6.0
MCE	6.7
TM	19.0

Three Trees Wind 0383 ET	LT Wyoming Wind 4020 Pld
BCR Wyoming 908 P	Three Trees Nancy 8121 ET
BCR Emily 124 Pld (*)	VCR Sir Duke 914 Pld
	BCR Ely 416 Pld
RAC Goosecreek 3043 Pld	BCR Polled Unlimited 003
BCR Babe 016 P/S	RAC Miss Kristy G5504 ET
BVF Babe 2552	BVF Chairman 8209 ET
	DC Miss Kelly 9224

- 30A - Polled bull calf born 12-14-13, BW 77, and sired by LT BLUE VALUE 7903 ET. His EPDs are +7.0; +0.4; +30.0; +54.0; +8.0; +8.7; +23.0, exceeding the breed average for every trait.
- A superior heifer that is doing a nice job with her first calf, years of production ahead.

RICKETTS CHAROLAIS RANCH



CMC Miss Bluegrass 052 P

2-18-12 • Polled • F1157440

EPD - BK	
CE	2.1
BW	-0.8
WW	18.0
YW	34.0
MK	10.0
MCE	3.5
TM	19.0

LT Bluegrass 4017 P	LT Assertion 1277 P
SRC Bluegrass T09	LT Pearl's Breeze 2236 P
CJC MS Legend H124	LHD Schurrtop Legend
	CJC MS Dynasty F780
Ruth Sunrise 53Z	P-3 Sunrise 8-15X
Bar5 MS Ruth 2092 Pld	GDSF Miss Show Me 4U
Bar5 Duke 9072 Pld ET	BR Duke 261
	RC MS Bud 418 Polled

- 31A - Polled heifer calf born 1-15-14 and sired by COOLEY ROYCE 1107T39. Her EPDs are +2.4; +0.5; +22.0; +52.0; +16.0; +2.9; +21.0.
- She calved at 23 months of age, good fertility. The BLUEGRASS genetics have been well accepted across the breed. Selling open and ready to breed.

HALE FARMS

BRED COWS



RCR Miss Morgan 7757 P

10-4-07 • Polled • F1082810

EPD - DIR	
CE	6.5
BW	-0.5
WW	21.0
YW	26.0
MK	8.0
MCE	6.6
TM	18.0

LHD Cigar E46	LHD MR Perfect Y416
M6 Big Top 268 Pld ET	LHD MS Classic Bell X613
M6 MS Impressive 8380 Pld	JWK Impressive D040 ET
	Moore's MS Eliminator ET
WCR Sir Tradition 066	WCR Sir Tradition 4402
RCR Traditions 2540 (*)	Ideal 809 45 OF 25
RCR 8347 Polled	ASC Eliminator 032
	RCR Flashie Polled 6262

- Safe in calf to VPI FREE LUNCH 708T and due in early September. The projected EPDs for this calf are +7.8; -1.4; +29.0; +45.0; +7.0; +6.3; +21.0.
- Her dam is a full sister to the Trait Leading Sire RCR TRADITIONS NED. Selected, proven genetics. Her Rib Eye EPD is in the top 1% of all Charolais dams.

RICKETTS CHAROLAIS RANCH



Lot 32 - RCR Miss Morgan 7757 P



WH Casey 818 P

9-2-08 • Polled • F1099496

EPD - DIR	
CE	5.8
BW	0.5
WW	35.0
YW	60.0
MK	4.0
MCE	6.6
TM	21.0

LT Wyoming Wind 4020 Pld	Schurrtop 5627
LV Guardian Angel R34 Pld ET	LT Chap's Lady 2170P
Big Creek Angel P	ASC Eliminator 032
	Big CRK Babe Unlimited P
JWK Reality E142 ET	LHD MR Perfect Y416
WH Greta 8108 Pld	BR MS Real Silver 2663 ET
WH Opra 4043 Pld	WH Walsh 2020 Pld
	WH Miss Kay Gee 9137 Pld

- Safe in calf to WH TRIPLE PLAY 201, exposed 1-20-14 to 4-1-14. The projected EPDs for this calf are +7.3; +0.6; +28.0; +56.0; +8.0; +8.0; +22.
- An above average EPD profile with individual performance above herd average. A proven producer.

WINDY HILL CHAROLAIS

BRED HEIFERS



TB Rachael 214 P

9-11-12 • Polled • F1165849

EPD - BK	
CE	-1.4
BW	3.3
WW	41.0
YW	74.0
MK	16.0
MCE	-0.8
TM	37.0

HBR Cannon 2250 ET	VCR Sir Duke 914 Pld
TB Salmon 013P	HBR Lady GI 207 P ET
TB Elizabeth 732 P	JWK Choice Plus E203 ET
	TB Wind Wonder 861 P
TB Plus 426 P	TB Plus 206 P ET
TB Anna 744	JWK Imogene J124 ET
TLC Miss Stormy 2220P	TLC Direction 8032P ET
	LC Germaine

- Examine her performance a Yearling Weight of 977 Index 106, herd topping growth.
- Safe in calf to TB ADAM 209P, Lot 4, exposed since 11-27-14. The projected EPDs for this calf are +3.1; +2.3; +40.0; +73.0; +15.0; +3.8; +35.0.
- Growth EPDs in highest 3% and Milk in the top 5% of all non parents in the breed. Dam sells as Lot 21.

☞ BEBOUT CHAROLAIS ☞



FSR Erin 642

10-2-11 • Polled

EPD - PE	
CE	5.1
BW	0.3
WW	33.0
YW	65.0
MK	15.0
MCE	3.4
TM	32.0

WCR Sir Tradition 066 P	WCR Sir Tradition 4402 P
M6 Grid Maker 104 P ET	Ideal 809 45 OF 25
VCR Miss Mac IV 317 P	WCR Sir FA Mac 2244 P
	VCR Miss Duchess 113 Pld
VCR Sir Duke 914 Pld	WCR Sir Duke 761 P
JWK Clarice J139 ET P	WCR Miss Mac IV 534 P
JWK Clarice D050 ET	WCR Sir FA Mac 2244 P
	HBR Lady GI 201 P ET

- Safe in calf, bred 2-12-14 to WR WRANGLER W601. Projected EPDs are +8.6; -0.1; +46.0; +72.0; +5.5; +7.3; +29.0.
- What a breeding piece here. J139 is one of the lead donors in the Wright Charolais Program.
- GRID MAKER daughters are well proven in the breeding herd and when crossed with a donor of this caliber. Donor potential for sure.

☞ FIVE SPOKE RANCH ☞



FSR Sammie 445

9-9-11 • Polled

EPD - PE	
CE	4.5
BW	0.3
WW	31.0
YW	61.0
MK	5.5
MCE	3.1
TM	22.0

M6 Grid Maker 104 P ET	WCR Sir Tradition 066 P
M6 Right Now 5239 Pld ET	VCR Miss Mac IV 317
M6 MS E46's Duke 248 P ET	LHD Cigar E46 P
	M6 MS Duke 009 Pld
Schurrtop Bonanza Pld	Schurrtop DC Intimidator P
Thomas MS Bonanza 8698 P	Schurrtop 5002 P
Thomas MS Immortal 7300 P	Immortal
	Miss DG Courage 038 P

- Safe in calf, bred 2-12-14 to WR WRANGLER W601. Projected EPDs for this calf are +8.3; -0.1; +45.0; +70.0; +0.8; +7.1; +24.0.
- One of the few daughters of the legendary BONANZA and a half sister to FIREWATER'S dam ZSA ZSA.
- A good EPD profile and sired by a really good GRID MAKER son. Future earning power has a high ceiling.

☞ FIVE SPOKE RANCH ☞



TB Liz 217 P

9-22-12 • Polled • F1165847

EPD - BK	
CE	-1.1
BW	2.4
WW	36.0
YW	64.0
MK	12.0
MCE	-1.8
TM	30.0

HBR Cannon 2250 ET	VCR Sir Duke 914 Pld
TB Salmon 013P	HBR Lady GI 207 P ET
TB Elizabeth 732 P	JWK Choice Plus E203 ET
	TB Wind Wonder 861 P
WCR Impressive 8191P	JWK Impressive D040 ET
TB Leah 727 P	WCR Miss Paul 8041
TB Choice Girl 404 P	JWK Choice Plus E203 ET
	TB Bright Day 750 Pld

- Safe in calf, exposed to TB ADAM, Lot 4, since 11-27-13. Projected EPDs for this calf are +3.2; +1.8; +38.0; +68.0; +13.0; +3.4; +32.0.
- A feminine little lady with her Weaning and Yearling EPDs in the top 9% and 8%.
- Her pedigree is packed with breed Trait Leaders. Line bred to CHOICE PLUS.

☞ BEBOUT CHAROLAIS ☞



FSR Mary 637

10-9-11 • Polled

EPD - PE	
CE	5.9
BW	0.6
WW	35.0
YW	71.0
MK	13.5
MCE	4.7
TM	31.0

WCR Sir Tradition 066 P	WCR Sir Tradition 4402 P
M6 Grid Maker 104 P ET	Ideal 809 45 OF 25
VCR Miss Mac IV 317 P	WCR Sir FA Mac 2244 P
	VCR Miss Duchess 113 Pld
VCR Sir Duke 914 Pld	WCR Sir Duke 761 P
JWK Clarice J139 ET	WCR Miss Mac IV 534 P
JWK Clarice D050 ET	WCR Sir FA Mac 2244 P
	HBR Lady GI 201 P ET

- Safe in calf, bred 2-13-14 to LT LEDGER 0332. EPDs for this calf will be +6.9; -0.3; +35.0; +74.0; +12.8; +5.4; +31.0.
- Another GRID MAKER x J139 adds value to your herd with these two full sibs. Genetic progress comes faster with uniform genetics.
- Look at these big middled, moderate females and see potential.

☞ FIVE SPOKE RANCH ☞



FSR Kat 309

10-18-11 • Polled

EPD - PE	
CE	0.1
BW	1.2
WW	32.0
YW	53.0
MK	20.0
MCE	-0.2
TM	36.0

LHD Cigar E46 P	LHD MR Perfect Y416P
JDJ Smokester J1377 P ET	LHD MS Classic Bell X613
JD Miss Commander B308	TA 854 Show Commander
	LHD MS Classic Ali W177 P
VCR Sir Duke 914 Pld	WCR Sir Duke 761 P
JWK Clarice J139 ET	WCR Miss Mac IV 534 P
JWK Clarice D050 ET	WCR Sir FA Mac 2244 P
	HBR Lady GI 201 P ET

- Safe in calf, bred 2-12-14 to LT LEDGER 0332. Projected EPDs are +4.1; 0.0; +34.0; +65.0; +16.0; +2.9; +33.0.
- SMOKESTER out of the J139 donor and she is good. These genetics are proven with full brothers demanding top dollar.
- The SMOKESTER daughters are highly maternal. She is a future donor and capitalize on this genetic package.

☞ FIVE SPOKE RANCH ☞



JWK Clarice J139 ET

OPEN HEIFERS

40

KC MS McHenry's Blue

9-9-12 • Polled • F1162964

EPD - PE	
CE	7.0
BW	-0.9
WW	26.0
YW	52.0
MK	9.0
MCE	6.7
TM	21.0

LT Assertion 1277 P	Eatons Assert 9171
LT Bluegrass 4017 P	LT Alli's Class 9140 P
LT Pearl's Breeze 2236 P	LT Wyoming Wind 4020 Pld
	LT Unlimited Pearl 7053P
M6 Grid Maker 104 PET	WCR Sir Tradition 066
DC MS Pomona 066 Grid C300	VCR Miss Mac IV 317
Hales MS McHenry 2113	Keys McHenry 24M
	WM MS Tradition 213 Pld

- Selling open and ready to move into your spring calving program.
- Calving Ease and Growth here, out of a great Corman cow.
- BLUEGRASS, WYOMING WIND, GRID MAKER, and McHENRY, it does not get much better.

☞ KINNEY CHAROLAIS ☞

42

JSF Smokester Marie 9292

9-29-12 • Polled • F1164189

EPD - BK	
CE	-3.0
BW	2.7
WW	21.0
YW	35.0
MK	18.0
MCE	4.5
TM	29.0

JDJ Smokester J1377 P ET	LHD Cigar E46
RLL MR Riverdale H170	JD MS Commander B309
RLL MS Eaton Sign E263 P	Schurrtop RC Signature
	Eatons Sandra 1769
BCR Longbranch 412 Pld	LT Polled Value 9089
BCR Marietta 915 P	Miss HCR Flash 7044 Poll
GPN Miss Megan 7N31 P	HTA Tatonka Pld 474D ET
	GPN Miss Megan 5N36 P

- Selling open, SMOKESTER females continue to shine in the pasture.
- A big middled girl from a long time breeder Jewel Spurlock.
- Her pedigree is stacked with good ones.

☞ SPURLOCK CHAROLAIS ☞

44

TNT Imaflirt A54 P

2-11-13 • Polled • F1162781

EPD - PE	
CE	6.2
BW	-0.5
WW	26.0
YW	47.0
MK	6.0
MCE	5.9
TM	20.0

WC-WCCC Rocketfuel 7109	PF Impressed 620 P ET
WC-TNT Apollo 9027 P	SCC Miss 3027 ET
Miss HCR Wendy 7000 Pld	ET Western Edge 4057 Pld
	Miss HCR Randi 5002 Pld
LT Wyoming Wind 4020 Pld	Schurrtop 5627
HF Shesa Flirt T1199	LT Chap's Lady 2170P
M6 066 Nancy 1199 P ET	WCR Sir Tradition 066
	VC Miss Mac IV 317

- Sells open, a WYOMING WIND granddaughter that has Calving Ease EPDs, with the growth numbers above breed average.
- Her sire from the Derry Wright herd is doing a good job back east.

☞ HALE FARMS ☞

46

RS Mysterious Girl 3713

3-2-13 • Polled

EPD - BK	
CE	N/A
BW	0.0
WW	24
YW	36
MK	6.5
MCE	N/A
TM	19

CJC Illusion N111	LHD Perfect Ali G1312 ET
RE Mystery 829 ET	CJC MS Productive K1645
RE MS Duke 34 ET	LHD Cigar E46 P
	CR Miss Duke 172
MR San Lorenzo 7816 P	MR San Lorenzo 5833
RS MS Lorenzo 37A P	MS San Lorenzo 4785
JN Chickadee 37	JN Lusty 466
	JN Miranda

- The MYSTERY bull is doing a super job at Rocking S Ranch.
- A MYSTERY daughter was a highlight of the Ft. Worth Sale, going to the Dennis herd.
- Ready to breed to the bull of your choice.

☞ ROCKING S RANCH ☞

41

JSF Grid's Macali 9182

9-18-12 • Polled • F1164188

EPD - BK	
CE	-0.9
BW	2.8
WW	31.0
YW	54.0
MK	7.0
MCE	-0.5
TM	22.0

WDZ Firemaker 6062 P ET	M6 Grid Maker 104 PET
Baney Firemaker SR 0035	Thomas Swisser Sweet 1764ET
Baney PR-Grid Fraze IB2	M6 Grid Maker 104 PET
	Baney Prime Fraze 1B
M6 Power Bud 251 Pld ET	RC Budsmydad 225 Polled
BF MS Bud 5122	RE MS Excellence 012 PET
BCF Lady Madison 91	JWK Madison E187 ET
	Boothes Miss Mac 9677P

- Her sire is linebred to the great GRID MAKER, quality plus!
- Balanced EPDs makes her an excellent breeding piece.
- She had been held open for a spring calving program. It is her kind that will be needed to rebuild the nations cow herd.

☞ SPURLOCK CHAROLAIS ☞

43

RS Triple Treat

2-5-13 • Polled

EPD - PE	
CE	3.1
BW	1.3
WW	31.0
YW	52.0
MK	3.5
MCE	4.8
TM	19.0

LT Wyoming Wind 4020 Pld	Schurrtop 5627
CWC Trifecta J825 P	LT Chap's Lady 2170 P
LOF Marigold Charm 60M P	LHD Cigar E46 P
	JWK Ganjah G074 ET P
RCR Wide One W552	RC Denver 6026 Pld
RS MS Wide Wind 533A P	RCR MS Cameo F180 P
RCR Cool Whirl Wind Y533 P	Hales Mr. Coal P
	RCR MS Whirlwind N021

- An exciting daughter of the TRIFECTA bull, a powerhouse WIND x CIGAR son who is creating a stir.
- This Okie girl has proven genetics and is from the top of the replacement herd.

☞ ROCKING S RANCH ☞

45

Hales MS Distance 311

3-11-13 • Polled • F1179008

EPD - PE	
CE	3.1
BW	0.3
WW	32.0
YW	54.0
MK	16.0
MCE	0.0
TM	32.0

LT Silver Distance 5342P	LT Silver Yield 3196 P
LT Long Distance 9001 Pld	LT Mattie 9026 Polled
LT Belle 7026 P	LT Easy Pro 1158 Pld
	LT Belle 5110 Pld
Eatons Truevalue 1026	LT Polled Value 9089
VCR Miss Value 0139 P	Eatons Wanetta 9572
VCR Miss Duchess 574 P	VCR Sir Duke 914 Pld
	VCR Miss Gossip 882

- A fancy open heifer that was bred in the Vedvei herd. She's good!
- Weaning and Yearling EPDs in the top 25% of all non parents. The Milk is in the best 5%.

☞ HALE FARMS ☞

47

SKS Gold Digger A37P

3-1-13 • Polled • F1163539

EPD - BK	
CE	3.4
BW	-0.7
WW	23.0
YW	41.0
MK	0.0
MCE	3.8
TM	11.0

SVY Freedom Pld 307N	HFCC Pld Evolution 5L
DCF Fortune 0244 P	SVY Purrfect 184L
DCF Polled Gold 591	SR/NC Field Rep 2158 P ET
	DCF AJ's Doll 001K P (*)
LC Suspect 0109 P ET	LT Wyoming Wind 4020 Pld
MS Cooley Suspect 863U5	LC Miss Laci Cae 104
MS Cooley Jackpot 863S3	CCR Jackpot 1410K5 PET
	MS Cooley CHC 863P ET

- She combines CAMP COOLEY genetics with a really good FIELD RED son that is out of the top donor at Dennis Charolais.
- The FORTUNE daughters have been well accepted, Doug Thurneau selected a half sister last fall to show.

☞ SKEANS CATTLE CO. ☞



DWC Grids Girl 2033 P

3-21-13 • Polled • F1169493

EPD - PE			
CE	4.5	WCR Sir Tradition 066	WCR Sir Tradition 4402
BW	0.5	M6 Grid Maker 104 PET	Ideal 809 45 OF 25
WW	30.0	VCR Miss Mac IV 317	WCR Sir FA Mac 2244
YW	56.0		VCR Miss Duchess 113 Pld
MK	15.0	DCF Fieldman 6001	SR/NC Field Rep 2158 P ET
MCE	3.9	007 Miss Fieldgirl 1173	DCF AJ's Doll 001K P (*)
TM	30.0	Miss 007 Elvira 46 7	MR HGW Track Star
			Watje Elvira 46M

- Here is a solid breeding piece to add to your replacement herd.
- She brings a solid cow power pedigree with such greats as GRID MAKER, 066, 2244, and FIELD REP.
- Long bodied with plenty of capacity with a top 10% REA.

☞ HANKINS FARMS ☞



WH Kalie 339 Pld

11-14-13 • Polled • F1179273

EPD - BK			
CE	4.1	PF Paratrooper 8235 P	Three Trees Wind 3001 ET
BW	1.6	JASR Wing Man 46X	PF Miss Paradise 2155 P
WW	34.0	JASR Fergie 47 T Pld	TLC Integrity 5087P ET
YW	58.0		Ace MS Megan Elk 09910-70R
MK	2.0	LV Guardian Angel R34 Pld ET	LT Wyoming Wind 4020 Pld
MCE	6.1	WH Casey 818 P	Big Creek Angel P
TM	19.0	WH Greta 8108 Pld	JWK Reality E142 ET
			WH Opra 4043 Pld

- Check out this fancy show prospect, that can be an excellent prospect for the summer shows.
- A pedigree stacked with show winners.
- Her Weaning EPD is in the highest 15% of the breed.

☞ WINDY HILL CHAROLAIS ☞

FROZEN SEMEN

Much of this semen will be at the sale site.
Bring your tank and save on shipping.

LOT	UNITS	SIRE
50	10	LT Bridger 9191 Pld
51	10	M6 Deep Stack
52	9	HBR Equalizer 940 P ET
53	7	CJC Trademark H 45

☞ HALE FARMS ☞

54	10	SCR Bronco 9026
55	10	SCR Bronco 9026

New herd sire for Lindskov-Thiel and Wild Indian Acres. His progeny are exciting.

56	10	PF Impressed 620 P ET
57	10	PF Impressed 620 P ET

IMPRESSED has been consistent for years.

☞ WILD INDIAN ACRES ☞

58	10 straws	Sparrows Sanchez
59	10 straws	LT Western Spur

Two proven sires that can improve herd quality.

☞ BANEY CHAROLAIS ☞

FROZEN EMBRYOS

Lot Units

Matings

- 60 6 HBR Lady Performer 934 x WCR Sir Mac 2244
A great donor. 127 progeny registered with the AICA, including JWK CHOICE PLUS, JWK RUBY 205 and JWK VANESSA D029.
- 61 6 DWC Lady Mac 2028 P ET x VCR Sir Duke 914 Pld
- 62 6 Bar 5 Desire P 37P ET x VCR Sir Duke 914 Pld
Full sisters daughters of LADY PERFORMER and WCR SIR MAC 2244.
Full sisters to VANESSA D029, a donor with 100 registered progeny.
Another full sister sold in the National Sale 2014 for \$15,000.
- 63 3 Bar 5 Miss Preview 418 P x WCR Sir Tradition 066
Her dam is the only full sister to BUDSMYDAD.
- 64 3 Bar5 MS Desire 3047 x LHD Ali Mark T 214
She is a 914 daughter of Lot ?.
☞ DOUBLE W CHAROLAIS ☞
1 guaranteed pregnancy per 3 embryos.
- 65 3 LC MS Maker 6015 PTW x LT Ledger 0332
LEDGER and GRID MAKER, a cross that is really working.
- 66 3 BPC Miss Charlot BU42P x M6 Bells & Whistles 255 P
BELLS & WHISTLES is a genetic Power House and CHARLOT is an ultra feminine daughter of EASY PRO.
☞ SKEANS CATTLE CO. ☞
1 guaranteed pregnancy per 3 embryos.
- 67 3 TR MS Cigar 5785 R ET x M6 Grid Maker 104 P ET
Proven genetics, GRID MAKER and a full sister to the great ZSA ZSA cow.
A full sib to this mating recently sold for \$35,000.
☞ FOX HOLLOW FARMS ☞
1 guaranteed pregnancy per 3 embryos.
- 68 2 ACE MS Wienk 717880 P125
x
M6 New Standard 842 P ET
NEW STANDARD genetics are in demand.
Multiple Trait cattle that consistently produce.
- 69 2 Three Trees Nancy 2416 x M6 Grid Maker 104 P ET
A full sister to WIND 0383 and GRID MAKER.
A proven mating that has worked time and time again.
- 70 2 Ace MS Wienk 717880P125 x DA Passport 502 P ET
☞ WILD INDIAN ACRES ☞
1 guaranteed pregnancy per pair.
- 71 3 B/T Ms Hoo Doo 6017-460 ET x LT Ledger 0332
- 72 3 B/T Ms Hoo Doo 6017-460 ET
x
M6 Bells & Whistles 255P
6017-460 full sister to SMART CHOICE and a half sib to this year's Reserve National Champion female.
☞ BANEY CHAROLAIS ☞
1 guaranteed pregnancy per 3 embryos.



JWK Vanessa D029



MV 934 Venessa 280 ET
Full sister to D029



M6 Bells & Whistles 255P



B/T MS Hoodoo 6017-460 ET

The guarantees on the Frozen Embryos are under the condition that the transplant work is done by an embryologist approved by the seller.

CONSIGNORS

BANEY CHAROLAIS

Dr. Larry Baney • Mountain Grove, MO
(417) 926-3471
Lot # 17, 58, 59, 71, 72

BEBOUT CHAROLAIS

Theodosia, MO
(417) 273-4279
Lot #s 4, 21, 22, 34, 35

BEISWINGER CHAROLAIS

Gil & Beverly Beiswinger • Halfway, MO
(417) 253-4304
Lot # 9, 30

BIG CREEK CHAROLAIS

Jeannine Doughty • Harrisonville, MO
(816) 616-8838
Lot #s 10, 11, 14

CORMAN CHAROLAIS

Dan & Connie Corman • Pomona, MO
(417) 469-3936 - (417) 252-1373
Lot #s 12, 19, 27

DOUBLE W CHAROLAIS

Paul Wimsatt • Verona, MO
(417) 737-0991
Lot #s 60, 61, 62, 63, 64

FIVE SPOKE RANCH

Mike Doyle • Elgin, OK
(580) 691-6477
Lot # 36, 37, 38, 39

FOX HOLLOW FARMS

Stephen Mellott • Catoosa, OK
(918) 409-6068
Lot # 67

G 4 RANCH

Ronnie Grass • Bonne Terre, MO
(573) 883-6765
Lot # 13

HALE FARMS

Rick Hale • Louisburg, MO
(417) 838-7251
Lot #s 3, 31, 44, 45, 50, 51, 52, 53

HANKINS FARMS

Don & Jason Hankins • Springfield, MO
(417) 861-2316
Lot #s 14, 48

KINNEY CHAROLAIS

Jim & Karen Kinney • Lamar, MO
(417) 682-6103
Lot #s 2, 8, 40

LINK CHAROLAIS

Chris Link • Center, TX
(936) 590-2949
Lot #s 20, 23

PETERSON FARMS CHAROLAIS

Steve & Sandy Peterson • Mtn. Grove, MO
(417) 926-5336 • (417) 259-1493
Lot # 3

RICKETTS CHAROLAIS RANCH

Rex & Sondra Ricketts • Hallsville, MO
(573) 696-3088 - (573) 808-6286
Lot #s 6, 7, 24, 32

ROCKING S RANCH

Charles Smith • Jenks, OK
(918) 663-9594
Lot #s 26, 43, 46

SKEANS CATTLE CO.

David Skeans • Gainesville, TX
(985) 870-4113
Lot #s 18, 47, 65, 66

SPURLOCK CHAROLAIS

Jewell Spurlock & Wesley Benton • Judsonia, AR
(501) 729-3695
Lot #s 41, 42

WILD INDIAN ACRES

Mike & Sara Kisner • House Springs, MO
(636) 274-9515 - (636) 236-0306
Lot #s 1, 15, 16, 28, 29, 56, 57, 68, 69, 70

WINDY HILLS CHAROLAIS

David & Annette Bonacker • Cedar Hill, MO
(636) 285-1656 - (314) 974-5230
Lot #s 5, 25, 33, 49



P.O. Box 308

Koshkonong, MO 65692

ADDRESS SERVICE REQUESTED

DATED MATERIAL

OR CURRENT RESIDENT

FIRST CLASS

FIRST CLASS
U.S. Postage
PAID
PERMIT #8
West Plains
MO 65775